

Using a Sunnyvale Public Library Chromebook

A quick guide to get you started.

Connect to a Wi-Fi Internet Connection

- If you borrowed a Chromebook bundle with an Internet To-Go Hotspot, the Chromebook will automatically connect to the provided hotspot (power the hotspot on first before turning on the Chromebook).

Find pre-installed applications by using the Launcher Icon  located in the bottom left of the screen.

- Use the “up” arrow on the menu that pops up to view all applications.

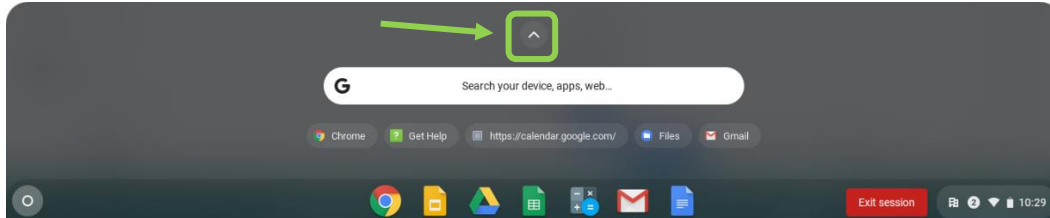

Access Google’s official help guides (including videos).

- **Note: some actions described will not be possible on this borrowed device.**

To access the built-in Help on this Chromebook

- Select the Launcher Icon and select the “up” arrow on the menu that pops up to view all applications.
- Select the “Get Help” icon.

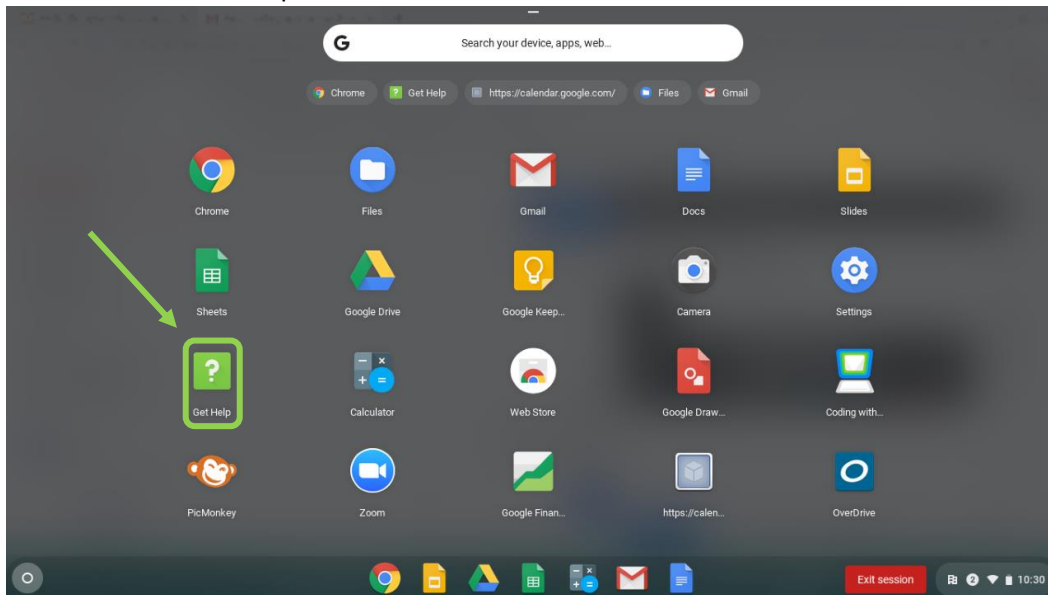

- **Note: some actions described will not be possible on this borrowed device.**

Get More Help from the Library!

- Find answers and get assistance on our online Virtual Assistance site
- Call us at 408-730-7300
- Make an appointment for 1-on-1 live help with Get Connected